

Unicast Ceramic-Lined Pipes & Elbows

Maximum Durability for Wearlife Savings



Ceramic Liners Extend Wearlife: Pipes and elbows completely lined with a 1/2"-thick cast ABSC20 sleeve, increasing wear life by over 10 times compared to unlined pipes and elbows. Cast in one piece for maximum durability, Unicast ceramic liners serve as an internal shield protecting pipes and elbows from high abrasion.

High-Wear Areas Protected: Designed to match standard pipe flanges for easy installation in high-wear areas of the pipeline only. Maximum long-term cost-savings in replacement parts and downtime.

Proven Worldwide Since 1994: Unicast ceramic liners have an expected wear life of at least 25 years. Since our first installation, in 1994, we have never had to replace one. Cast one-piece ceramic liners are unique to Unicast.

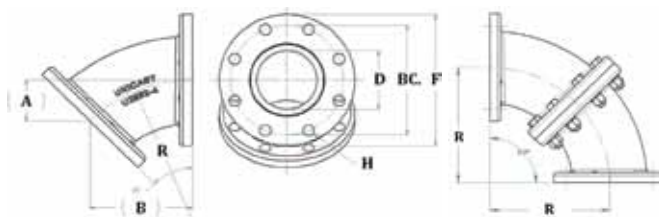
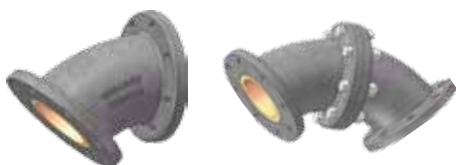

Ceramic-Lined Elbows

PART NUMBER	SIZE "D"	R	A	B	Bc	H	H #	F	WEIGHT
U2952-4A	4"	9.65"	2.83"	6.81"	7.52"	0.75"	8	9.06"	39.6 Lbs
	102mm	245mm	72mm	173mm	191mm	19mm		230mm	18 Kg
U2952-6A	6"	12.80"	3.74"	9.06"	9.49"	0.87"	8	11.02"	72.6 Lbs
	152mm	325mm	95mm	230mm	241mm	22mm		280mm	33 Kg
U2952-8A	8"	14.72"	4.25"	10.47"	11.73"	0.91"	8	13.50"	138.6 Lbs
	203mm	374mm	108mm	266mm	298mm	23mm		343mm	63 Kg
U2952-10A	10"	19.65"	5.75"	13.90"	14.25"	0.98"	12	15.98"	171.6 Lbs
	254mm	499mm	146mm	353mm	362mm	25mm		406mm	78 Kg
U2952-12A	12"	17.52"	5.12"	12.40"	17.01"	1.14"	12	19.49"	235.4 Lbs
	305mm	445mm	130mm	315mm	432mm	29mm		495mm	107 Kg
U2952-14A	14"	20.98"	6.14"	14.84"	18.70"	1.14"	12	20.98"	299.2 Lbs
	356mm	533mm	156mm	377mm	475mm	29mm		533mm	136 Kg
U2952-16A	16"	24.02"	7.05"	16.97"	21.26"	1.14"	16	23.50"	479.6 Lbs
	406mm	610mm	179mm	431mm	540mm	29mm		597mm	218 Kg
U2952-20A	20"	40.00"	11.73"	28.27"	25.00"	1.26"	20	27.52"	748 Lbs
	500mm	1016mm	298mm	718mm	635mm	32mm		699mm	340 Kg
U2952-24A	24"	48.03"	14.06"	33.94"	29.49"	1.38"	20	32.01"	1342 Lbs
	610mm	1220mm	357mm	862mm	749mm	35mm		813mm	610 Kg

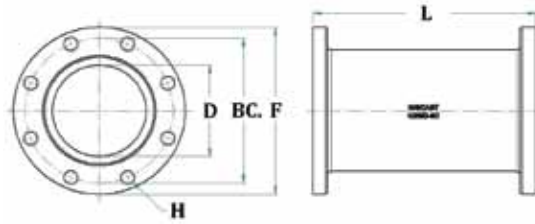

Ceramic-Lined Pipe Segments

PART NUMBER	SIZE "D"	L	Bc	H	H #	F	WEIGHT
U2953-4C	4"	10.24"	7.52"	0.75"	8	9.06"	46.2Lbs
	102mm	260mm	191mm	19mm		230mm	21 Kg
U2953-6C	6"	14.37"	9.49"	0.87"	8	11.02"	77.0 Lbs
	152mm	365mm	241mm	22mm		280mm	35 Kg
U2953-8C	8"	15.63"	11.73"	0.91"	8	13.50"	110.0 Lbs
	203mm	397mm	298mm	23mm		343mm	50 Kg
U2953-10C	10"	21.06"	14.25"	0.98"	12	15.98"	178.2 Lbs
	254mm	535mm	362mm	25mm		406mm	81 Kg
U2953-12C	12"	19.49"	17.01"	1.14"	12	19.49"	314.6 Lbs
	305mm	495mm	432mm	29mm		495mm	143 Kg
U2953-14C	14"	24.02"	18.70"	1.14"	12	20.98"	431.2 Lbs
	356mm	610mm	475mm	29mm		533mm	196 Kg
U2953-16C	16"	25.59"	21.26"	1.14"	16	23.50"	572 Lbs
	406mm	650mm	540mm	29mm		597mm	260 Kg
U2953-20C	20"	20.87"	25.00"	1.26"	20	27.52"	556.6 Lbs
	500mm	530mm	635mm	32mm		699mm	253 Kg
U2953-24C	24"	24.80"	29.49"	1.38"	20	32.01"	976.8 Lbs
	610mm	630mm	749mm	35mm		813mm	444 Kg

You May Also Need:

- ✓ Ceramic-Lined Slurry Valve

Crusher Parts

Hammers & Breaker Blocks

Apron Feeder Pans

Chute Liners

Mill Liners

Partition Grates

Cyclone Thimble Segments

Nose & Feed Ring Segments

Drag Chains

Clinker Breaker Hammers

Grizzly Panels

Clinker Cooler Grates

Shut-Off Valves

Diverter Valves

Sales Office and Plant CANADA

871 Stremel Road
Kelowna, BC Canada V1X 5E6
Tel: (250) 807-7999
Fax: (250) 807-7990
wearparts@unicast.ca
www.unicast.ca

Sales Office USA

2923 Robin Hood Lane
Fayetteville, AR USA 72703
Tel: (479) 444-1900
Fax: (479) 444-9838
jim@unicast.ca

Sales Office MEXICO

sales@unicastmexico.com
www.unicastmexico.com